

APPENDIX 3



North Tyneside Council

PREMISES LICENCE

Schedule 12 – Part A

Premises Licence number: 00CK/20/0444

Part 1 - Premises details

Postal address of premises:

Kork
74 Whitley Road
Whitley Bay
Tyne And Wear
NE26 2NE

Where the licence is time limited the dates:

Licensable activities authorised by the licence:

Supply of Alcohol

The times the licence authorises the carrying out of licensable activities:

Supply of Alcohol Monday to Saturday **From:**09:00 **Until:**21:00 and Sunday **From:**10:00 **Until:**16:00

The opening hours of the premises:

Monday to Saturday **From:**09:00 **Until:**21:00 and Sunday **From:**10:00 **Until:**16:00

Where the licence authorises supplies of alcohol whether these are on and/ or off supplies:

Off Premises

Part 2

Name, (registered) address, telephone number and email (where relevant) of holder of premises licence:

Mr Shawn Darling-Cooper

Registered number of holder, for example company number, charity number (where applicable):

Not applicable

Name, address and telephone number of designated premises supervisor where the premises licence authorises the supply of alcohol:

Mr Shawn Darling-Cooper

Personal licence number and issuing authority of personal licence held by designated premises supervisor where the premises licence authorises the supply of alcohol:

00CK/10/2756 North Tyneside Council

Annex 1 - Mandatory conditions

1. No supply of alcohol may be made under this premises licence:-
 - (a) at a time when there is no designated premises supervisor in respect of the premises licence or
 - (b) at a time when the designated premises supervisor does not hold a personal licence or his personal licence is suspended.
2. Every supply of alcohol under this premises licence must be made or authorised by a person who holds a personal licence.

The Licensing Act 2003 (Mandatory Licensing Conditions) Order 2010 - with effect from 1st October 2010 as amended on 1st October 2014

- 1.(1) The premises licence holder or club premises certificate holder shall ensure that an age verification policy applies to the premises in relation to the sale or supply of alcohol.
- (2) The designated premises supervisor in relation to the premise licence must ensure that the supply of alcohol at the premises is carried on in accordance with the age verification policy.
- (3) The policy must require individuals who appear to the responsible person to be under 18 years of age (or such older age as may be specified in the policy) to produce on request, before being served alcohol, identification bearing their photograph, date of birth and either -
 - (a) a holographic mark, or
 - (b) an ultraviolet feature.

The Licensing Act 2003 (Mandatory Licensing Conditions) Order 2014 with effect from 28th May 2014

1. A relevant person shall ensure that no alcohol is sold or supplied for consumption on or off the premises for a price which is less than the permitted price.
2. For the purposes of the condition set out in paragraph 1—
 - (a) "duty" is to be construed in accordance with the Alcoholic Liquor Duties Act 1979;
 - (b) "permitted price" is the price found by applying the formula—

$$P = D + (D \times V)$$

where—

- (i) P is the permitted price,
- (ii) D is the amount of duty chargeable in relation to the alcohol as if the duty were charged on the date of the sale or supply of the alcohol, and
- (iii) V is the rate of value added tax chargeable in relation to the alcohol as if the value added tax were charged on the date of the sale or supply of the alcohol;
- (c) "relevant person" means, in relation to premises in respect of which there is in force a premises licence—
 - (i) the holder of the premises licence,
 - (ii) the designated premises supervisor (if any) in respect of such a licence, or
 - (iii) the personal licence holder who makes or authorises a supply of alcohol under such a licence;
 - (d) "relevant person" means, in relation to premises in respect of which there is in force a club premises certificate, any member or officer of the club present on the premises in a capacity which enables the member or officer to prevent the supply in question; and
 - (e) "valued added tax" means value added tax charged in accordance with the Value Added Tax Act 1994.

3. Where the permitted price given by Paragraph (b) of paragraph 2 would (apart from this paragraph) not be a whole number of pennies, the price given by that sub-paragraph shall be taken to be the price actually given by that sub-paragraph rounded up to the nearest penny.

4. (1) Sub-paragraph (2) applies where the permitted price given by Paragraph (b) of paragraph 2 on a day ("the first day") would be different from the permitted price on the next day ("the second day") as a result of a change to the rate of duty or value added tax.

(2) The permitted price which would apply on the first day applies to sales or supplies of alcohol which take place before the expiry of the period of 14 days beginning on the second day.

Annex 2 - Conditions consistent with the operating schedule





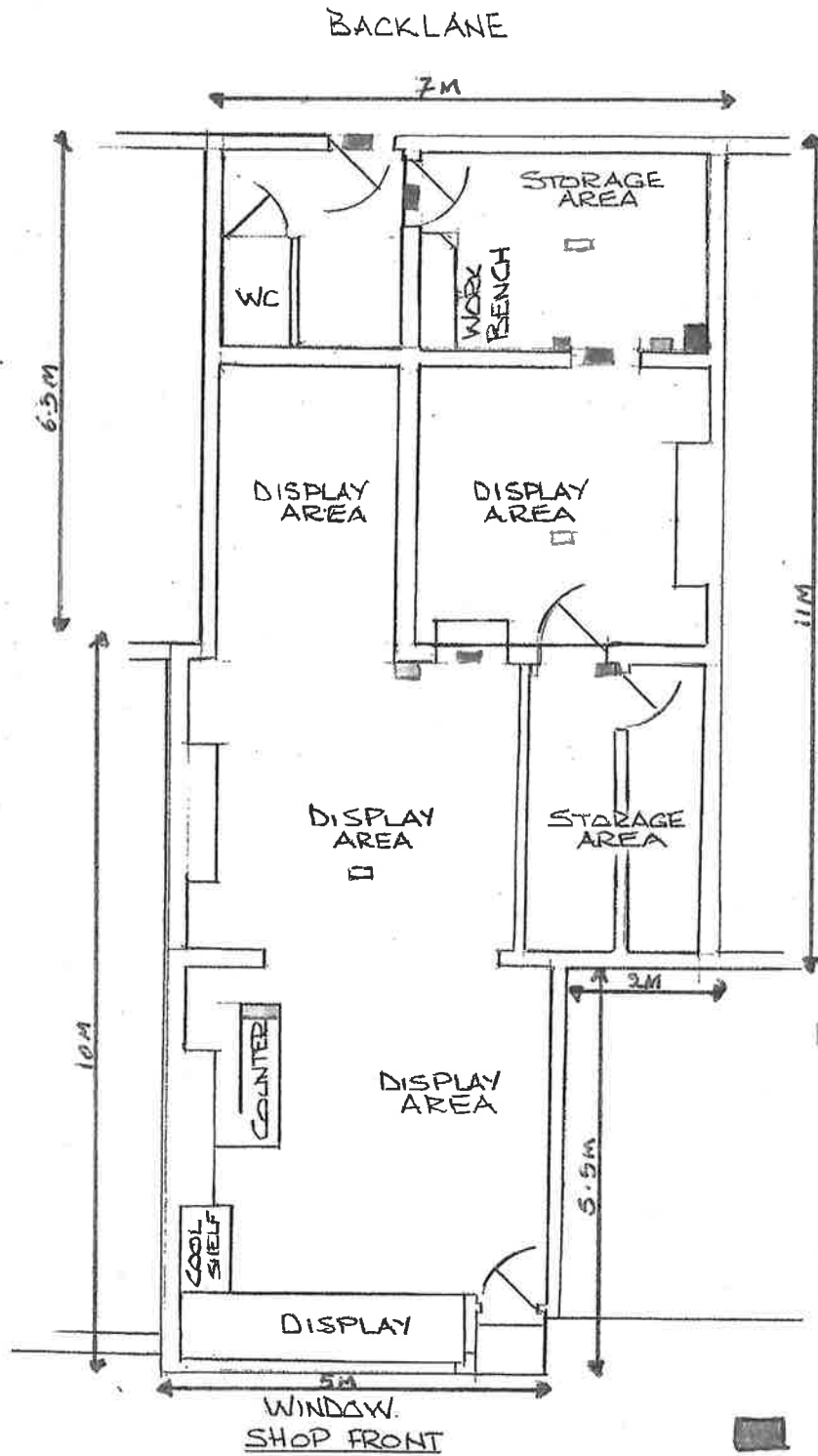

Annex 3 - Conditions attached after a hearing by the licensing authority

- 1. A CCTV system will be designed, installed and maintained in proper working order to the reasonable satisfaction of and in consultation with Northumbria Police and the Licensing Authority. Such a system shall:-**
 - (i) Be operated by properly trained staff.**
 - (ii) Provide continuous recording facilities for each camera to a good standard of clarity.**
 - (iii) Be retained on disk or otherwise.**
 - (iv) Ensure coverage of the entrance to the Licensed Premises, both internally and externally.**
 - (v) Ensure coverage of such other areas as may be required by Northumbria Police and Licensing Authority in consultation with the Licence holder.**
 - (vi) Ensure recordings are retained for a period of 28 days and will be supplied to the Licensing Authority or Northumbria Police representative on request.**
- 2. Signs are to be placed both internally and externally and the Premises indicating to customers that CCTV is in operation on the Premises. Signs are to be a minimum of A5 size.**
- 3. A member of staff is to be trained in the operation of the CCTV system and be able to download the images on request.**
- 4. All members of staff responsible for serving alcohol at the Premises shall seek credible photographic proof of age evidence from any person who appears to be under the age of 25 years and who is seeking to purchase alcohol. Such credible evidence, which shall include a photograph of the customer, will either be a current passport, photographic driving licence or proof of age card carrying the pass logo and hologram.**
- 5. All members of staff will have adequate training on the Licensing Act 2003 and any subsequent variation of the Act. This training will be delivered every 6 months for current staff and will be provided to any new member of staff. The training will be delivered by a personal licence holder. The training will be documented and kept on file for the inspection of a Trading Standards Officers, Licensing Authority Officers or Police representatives on request.**
- 6. The Designated Premises Supervisor is to provide written authorisation to all staff involved in the sale of alcohol. Such authorisation is to be retained as part of the staff training records.**
- 7. A refusals register (electronic or paper based) is to be kept and maintained on the Premises. This register shall be supplied promptly to a Police representative, Trading Standards Officer or Licensing Authority Officer on request.**
- 8. No open bottles or drinks containers are to leave the Premises.**

Annex 4 - Plans

See attached



- FIRE EXIT SIGNS 
- FIRE EXTINGUISHERS 
- SMOKE ALARMS 
- TORCHES 
- HOUSE KEEPING EQUIPMENT 
- FIRE ASSEMBLY POINT 

**NORTH TYNESIDE COUNCIL
LICENSING SECTION**

15 MAY 2013

APPROVED

PLAN OF PROPERTY AT
74 WHITLEY ROAD
 WHITLEY BAY
 NEWCASTLE UPON TYNE
 NE26 2NE

SCALE 1:100

