

APPENDIX 2

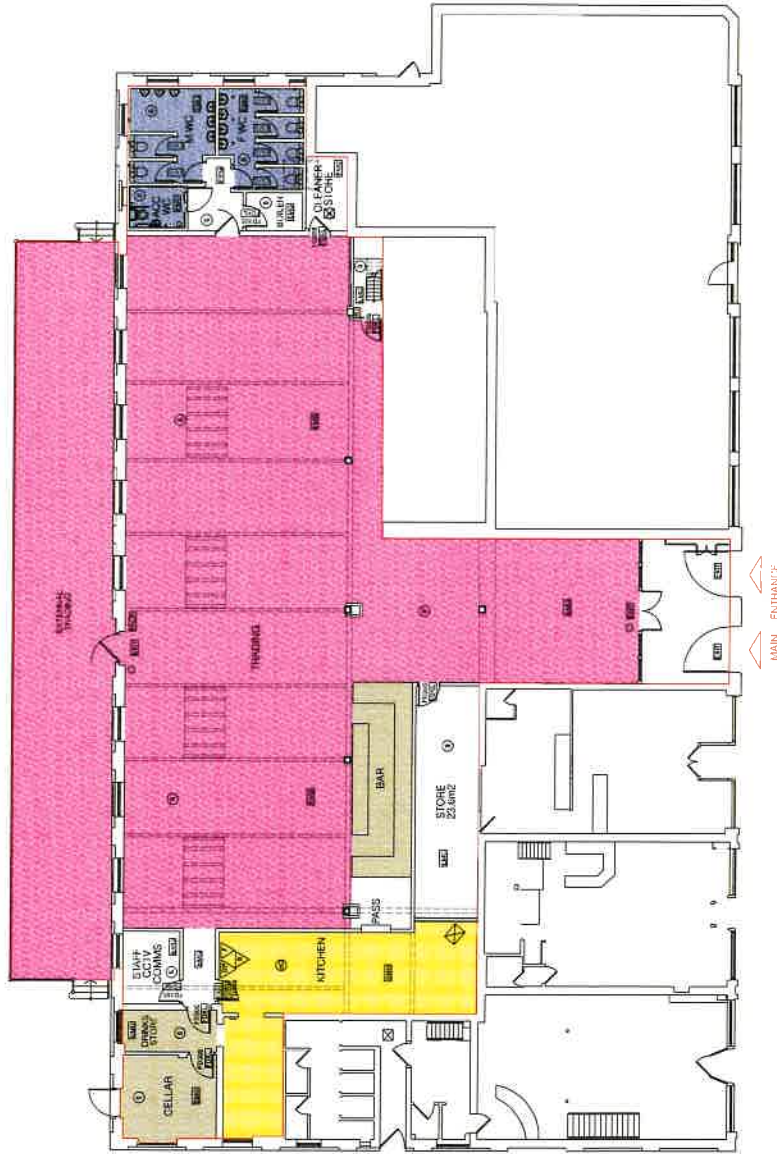

SEAFHONI

The entire premises is to be licensed for the sale of alcohol and the provision of late night refreshment



GROUND FLOOR PLAN - 1:100@A1, 1:200@A3



GRAND PARADE

- LICENSING KEY:**
- EXIT** (Symbol: Exit sign) Mandatory Fire Exit sign
 - CS** (Symbol: Break glass call point) Break glass call point for fire alarm in accordance with BS5849
 - FS30** (Symbol: Fire door) Fire door to provide min. 30 minutes fire protection
 - FOODS** (Symbol: Food icon) Fire door to provide min. 30 minutes fire protection and self-closing smoke barrier at ambient temperature is provided
 - ES** (Symbol: Fire extinguisher) Area for consumption of intoxicating liquor
 - ES2** (Symbol: Fire extinguisher) Area for storage of liquor bar counter
 - ES3** (Symbol: Fire extinguisher) Total accommodation
 - ES4** (Symbol: Fire extinguisher) Kitchen & staff areas
 - ES5** (Symbol: Fire extinguisher) Fire Alarm Control Panel
 - ES6** (Symbol: Fire extinguisher) Smoke detector
 - ES7** (Symbol: Fire extinguisher) Smoke detection alarm
 - ES8** (Symbol: Fire extinguisher) Heat detector
 - ES9** (Symbol: Fire extinguisher) Alarm receiver
 - ES10** (Symbol: Fire extinguisher) Emergency lighting in accordance with BS5266
 - ES11** (Symbol: Fire extinguisher) Fire alarm line in ceiling concealed duct
 - ES12** (Symbol: Fire extinguisher) 8 lbs fire alarm extinguisher
 - ES13** (Symbol: Fire extinguisher) 10kg dry powder fire extinguisher
 - ES14** (Symbol: Fire extinguisher) 10kg wet agent fire extinguisher
 - ES15** (Symbol: Fire extinguisher) Fire door keep closed
 - ES16** (Symbol: Fire extinguisher) Fire door keep closed

Richard Pidlar Architects
 100A Seafhoni Parade, 20 Auld Scotch Street
 www.richardpidlar.com

APPLICATION FOR PREMISES LICENSING

Richard Pidlar Architects
 100A Seafhoni Parade, 20 Auld Scotch Street
 www.richardpidlar.com

LOUNGE at Seafhoni, Seafhoni, Grand Parade, Seafhoni, ME23 4JY
 Local Authority: Lewisham Council

Ref: LK24/776/05-
 1:200@A3 (Rev. SEP 2023)